

## **KLIXON** | **FIXED TEMPERATURE THERMOSTATS**

*20490 and 20491 Series, Double Pole Automatic Reset*  
*20492 and 20493 Series, Double Pole Manual Reset*

### **AUTOMATIC RESET** **20490 and 20491 Series**

The high capacity automatic series are available as limit (L) switches which open on temperature rise and fan (F) switches which close on temperature rise.

### **MANUAL RESET** **20492 and 20493 Series**

The high contact capacity eliminates the need for costly back-up contacts and low capacity manual reset limit controls in electric heat applications.

Sensata Technologies has been a leading global supplier of sensors & switches for over 50 years.

### **Features**

- Double Pole Single Throw (DPST)
- Manual Reset/Trip free
- Automatic Reset
- Heavy Duty Capacity - up to 48 amperes per pole
- Snap-Action resists shock and vibration regardless of mounting position
- Tamperproof - temperatures are factory set to customer requirements
- Molded Phenolic Case - seals out lint, dust, and other contamination
- Compact - easily mounted where space is limited
- High Reliability

### **Automatic Reset**

The Klixon 20490 and 20491 series are especially designed for the electric heat, laundry, and other major appliance markets. The high capacity automatic series, (20490 and 20491) are available as limit (L) switches, which open on temperature rise, and fan (F) switches, which close on temperature rise.

The switch is enclosed within a phenolic housing and stainless steel cup assembly which protects the contacts from contamination. The stainless steel cup also provides a variety of mounting configurations.

The switch mechanism is actuated by the Klixon snap-action bimetal disc which may be enclosed or exposed. Enclosed disc types should be used in all applications where response to radiant heat is not critical as it provides protection (to the bimetal element and switch assembly) against contamination and damage due to handling. Exposed disc types are used in applications where a faster thermal response to radiant heat is required.

Standardized mounting-hole dimensions allow interchangeability with our present 204 and 206 series thermostats.

The 20490 is available with the following terminal configurations: 0.250" X 0.032" flat, 45°, and 90° male quick connect; 0.187" X 0.032" 90° male quick connect; flat and 45° #8-32NC screw terminals. Only 45° #10-24 screw terminals are available on the 20491.

### **Temperature Setting (°F)**

TEMP. RANGE	TOLERANCE		NOMINAL TEMP DIFFERENCE
	OPEN	CLOSE	
0 to 80	±6	±7	20 to 60
81 to 200	±5	±7	20 to 60
201 to 250	±6	±8	20 to 60
251 to 300	±7	±10	30 to 60

### **Electrical Clearances**

TYPE	THROUGH AIR	OVER SURFACE
20490	1/4"	3/8"
20491	3/8"	1/2"

### **Manual Reset**

The Klixon 20492 and 20493 series are especially designed for the electric heat and water heater markets. The high capacity eliminates the need for costly backup contacts and low capacity manual reset limit controls in electric heat applications. The contacts are enclosed for protection from contamination.

The 20492 and 20493 are designed for trip free operation. The trip free construction will not allow the contacts to be closed until the temperature of the disc is lowered to its reset point.



# FIXED TEMPERATURE THERMOSTATS

20490 and 20491 Series, Double Pole Automatic Reset  
20492 and 20493 Series, Double Pole Manual Reset

The 20492 is available with the following terminal configurations: 0.250" X 0.032" flat, 45°, and 90° male quick connect; 0.187" X 0.032" 90° quick connect; flat and 45° #8-32NC screw terminals. Only 45° #10-24 screw terminals are available on the 20493.

## Temperature Setting (°F)

OPENING TEMP. RANGE	TOLERANCE
100 to 200	±5
201 to 250	±6
251 to 300	±7

## Electrical Clearances

TYPE	THROUGH AIR	OVER SURFACE
20492	3/8"	1/2"
20493	3/8"	1/2"

## Electrical Ratings - Auto Reset

100,000 cycles/pole)

### 20490\*

Resistive	25 amperes at 240 VAC
Motor Load	10 FLA-60 LRA at 120 VAC 5 FLA-30 LRA at 240 VAC
Pilot Duty	125 volt-amperes at 120 VAC

### 20491\*

Resistive	25 amperes at 600 VAC
Motor Load	4 FLA-8 LRA at 480 VAC
Pilot Duty	690 volt-amperes at 240 VAC to 480 VAC

## Electrical Ratings - Manual Reset

(6,000 cycles/pole)

### 20492\*

Resistive	25 amperes at 600 VAC
Motor Load	10 FLA-60 LRA at 120 VAC 5 FLA-30 LRA at 240 VAC
Pilot Duty	690 volt-amperes at 240/600 VAC 480 volt-amperes at 120 VAC

### 20493\*

Resistive	48 amperes at 600 VAC
Motor Load	16 FLA-96 LRA at 120 VAC 8 FLA-48 LRA at 240 VAC
Pilot Duty	690 volt-amperes at 240/600 VAC 480 volt-amperes at 120 VAC

\*UL Recognized component for USA and Canada  
File MP986  
U.S. Category MBPR2  
Canada Category MBPR8

**A Sensata sales representative, who knows your temperature control problems and how our products solve them, is located close at hand. Use his or her services to eliminate needless engineering cost and give your products a competitive edge.**

(All dimensions are in inches unless otherwise noted.)

### 20490 and 20491

Standard 0.250 wide X 0.032 thick spade type quick connect terminals mate with any standard amp or ark-less female terminal

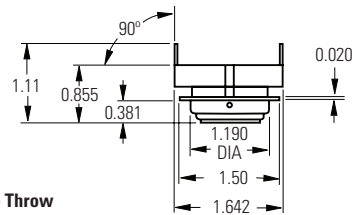
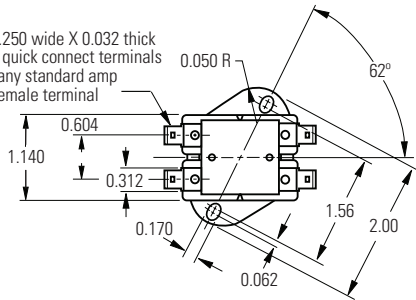

Double Pole, Single Throw  
Small Oval Flange  
Top Mounting  
Quick Connect Terminal

### 20492 and 20493

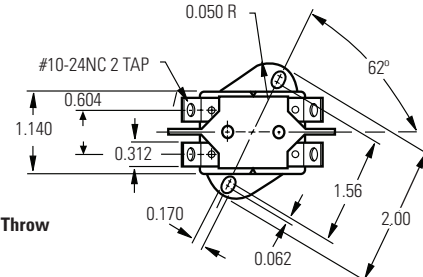

Double Pole, Single Throw  
Manual Reset  
Small Oval Flange  
Top Mounting  
Screw Type terminals

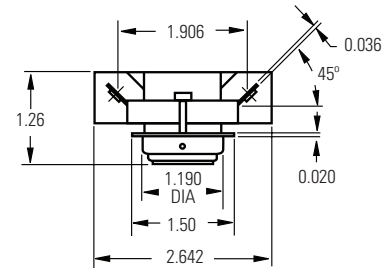

The World Depends on Sensors and Controls

## Sensata Technologies

529 Pleasant Street, MS B19  
Attleboro, MA 02703-2964

Phone 1-888-438-2214  
1-508-236-1894

Fax: 508-236-2349  
email: [sensors@sensata.com](mailto:sensors@sensata.com)  
[www.sensata.com](http://www.sensata.com)

**Important Notice:** Sensata Technologies (Sensata) reserves the right to make changes to or discontinue any product or service identified in this publication without notice. Sensata advises its customers to obtain the latest version of the relevant information to verify, before placing any orders, that the information being relied upon is current. Sensata assumes no responsibility for infringement of patents or rights of others based on Sensata applications assistance or product specifications since Sensata does not possess full access concerning the use or application of customers' products. Sensata also assumes no responsibility for customers' product designs.